

# DENAH RUANG TES SBM

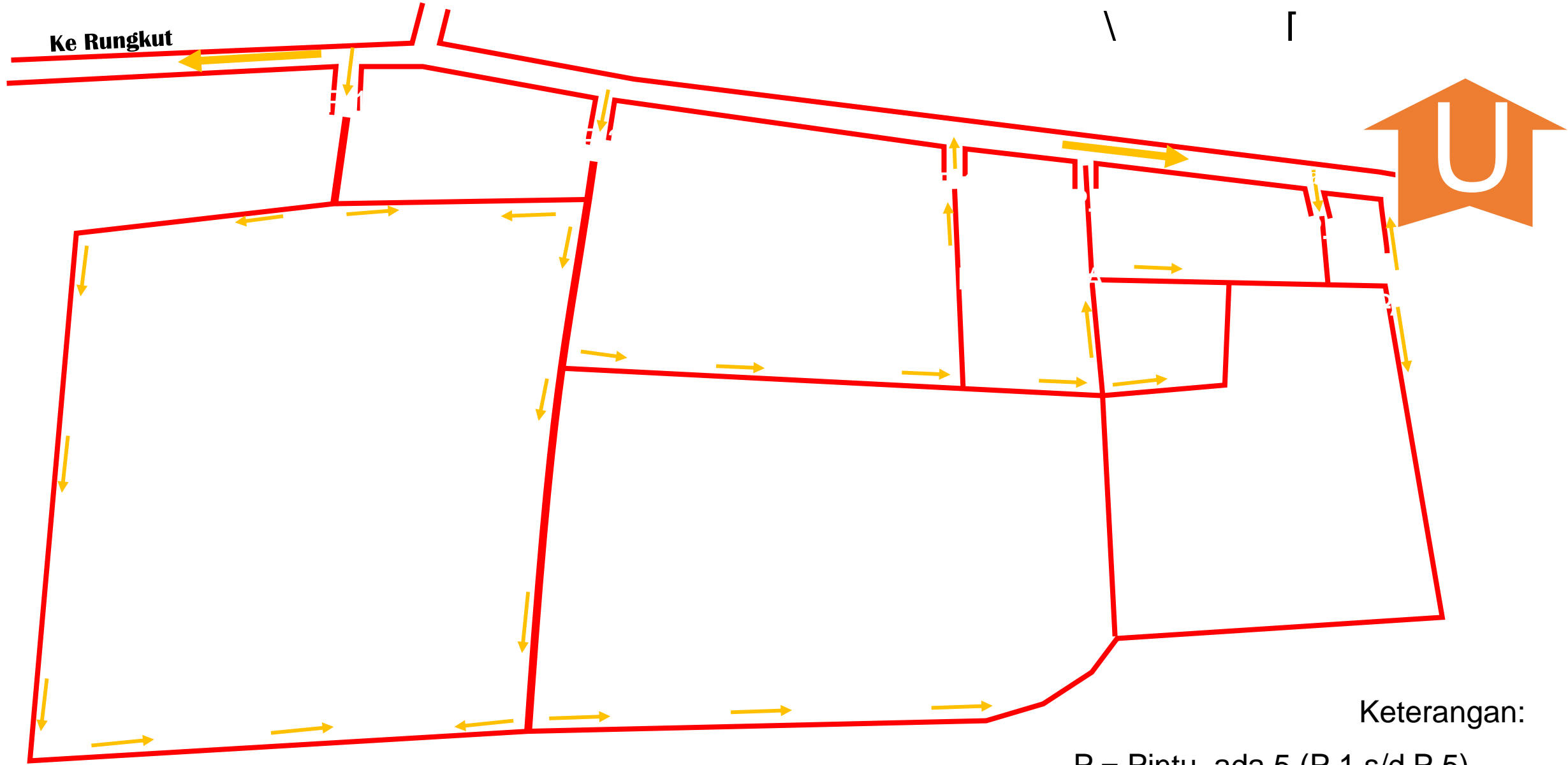

Keterangan:

- P = Pintu ada 5 (P.1 s/d P.5)
- Rute Jalan dalam Kampus
- Arah Perjalanan dlm Kampus

# DENAH RUANG UJIAN SBMPTN FEB - A

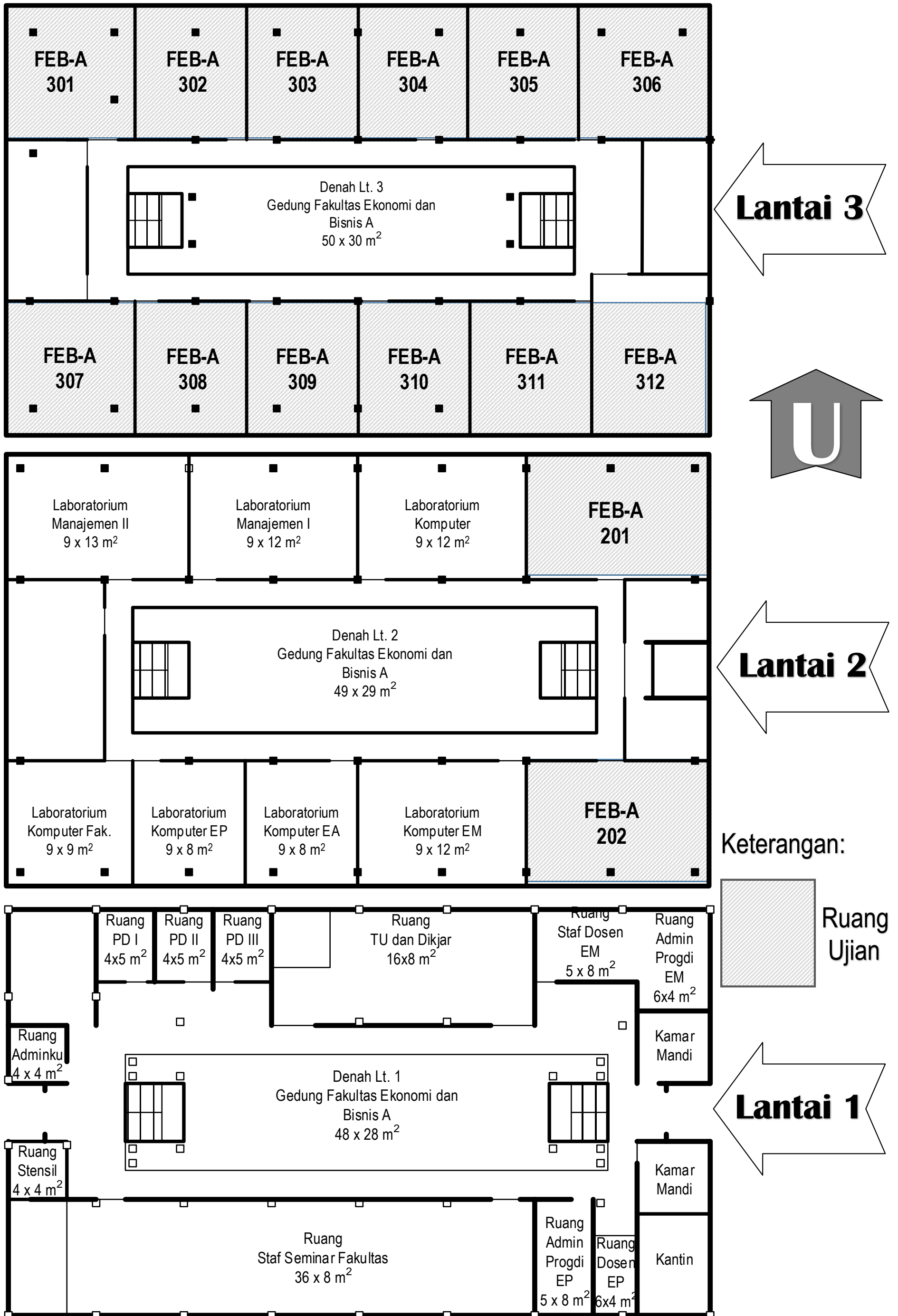

# DENAH RUANG UJIAN SBMPTN FEB - B

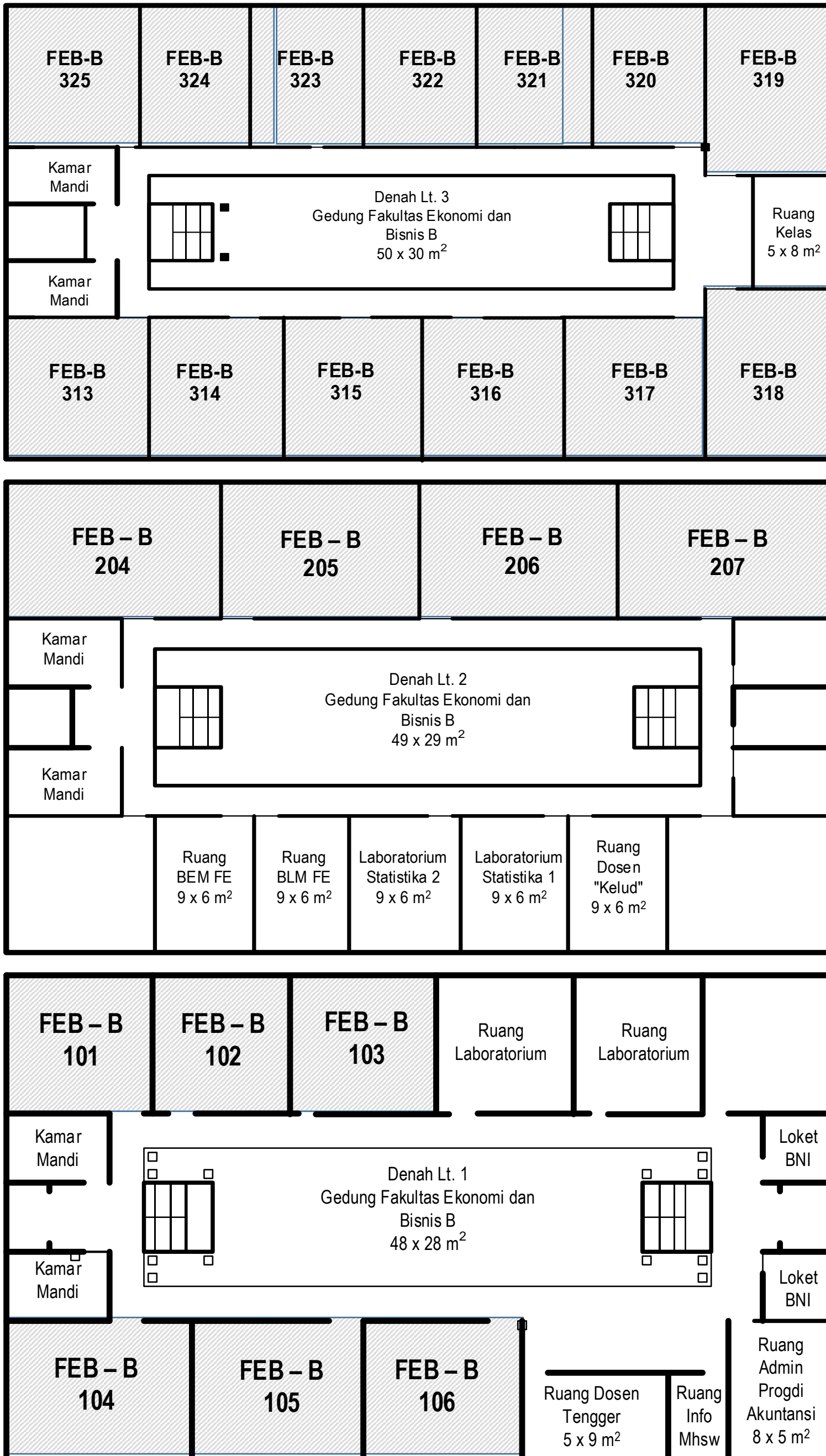

**Lantai 3**

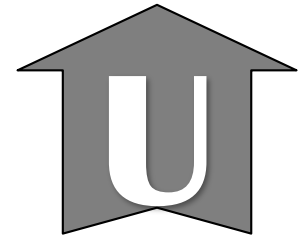

**Lantai 2**

Keterangan:

 Ruang Ujian

**Lantai 1**

# DENAH RUANG UJIAN SBMPTN FP

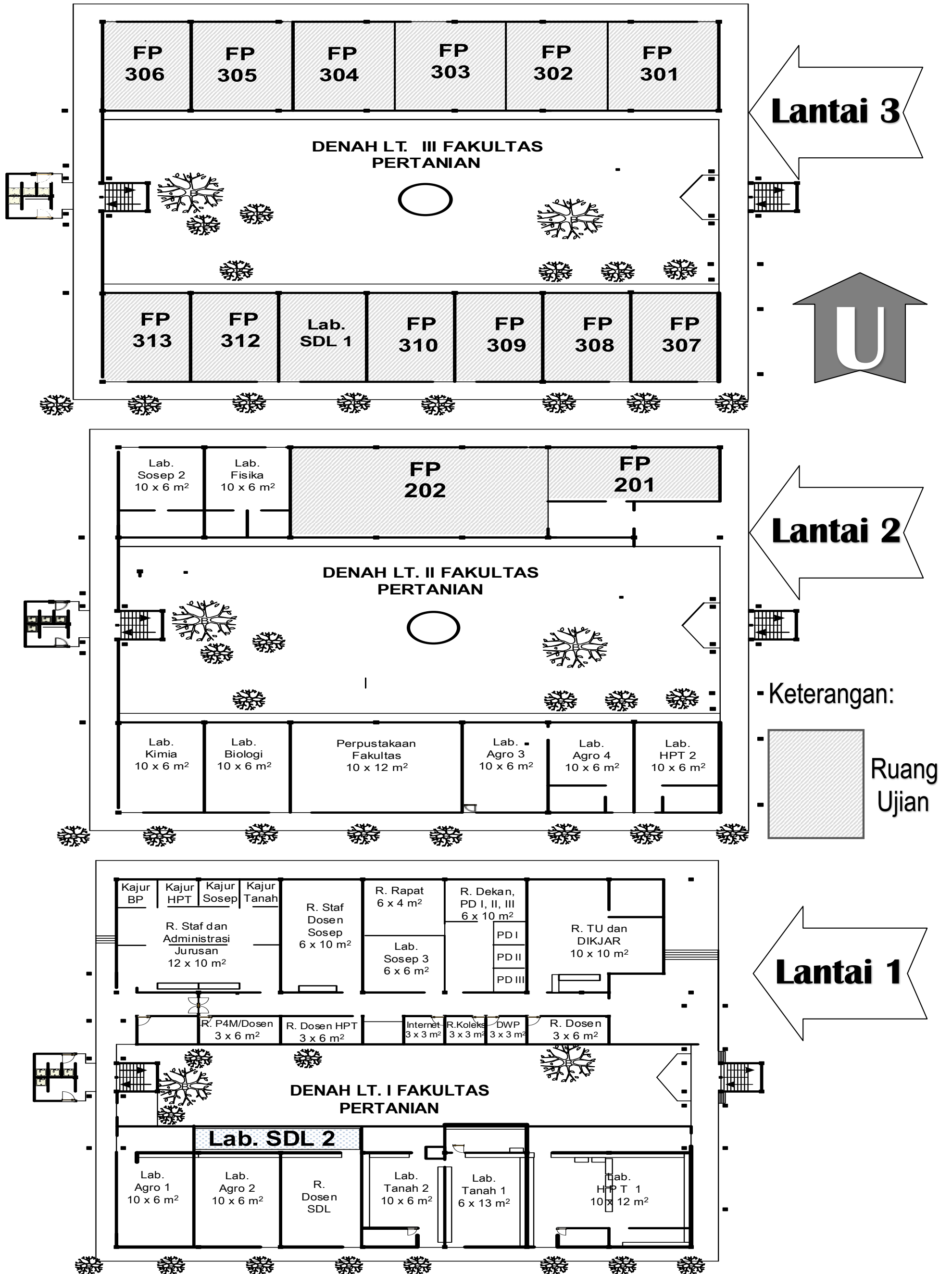

# DENAH RUANG UJIAN SBMPTN FT - A



# DENAH RUANG UJIAN SBMPTN FT - B

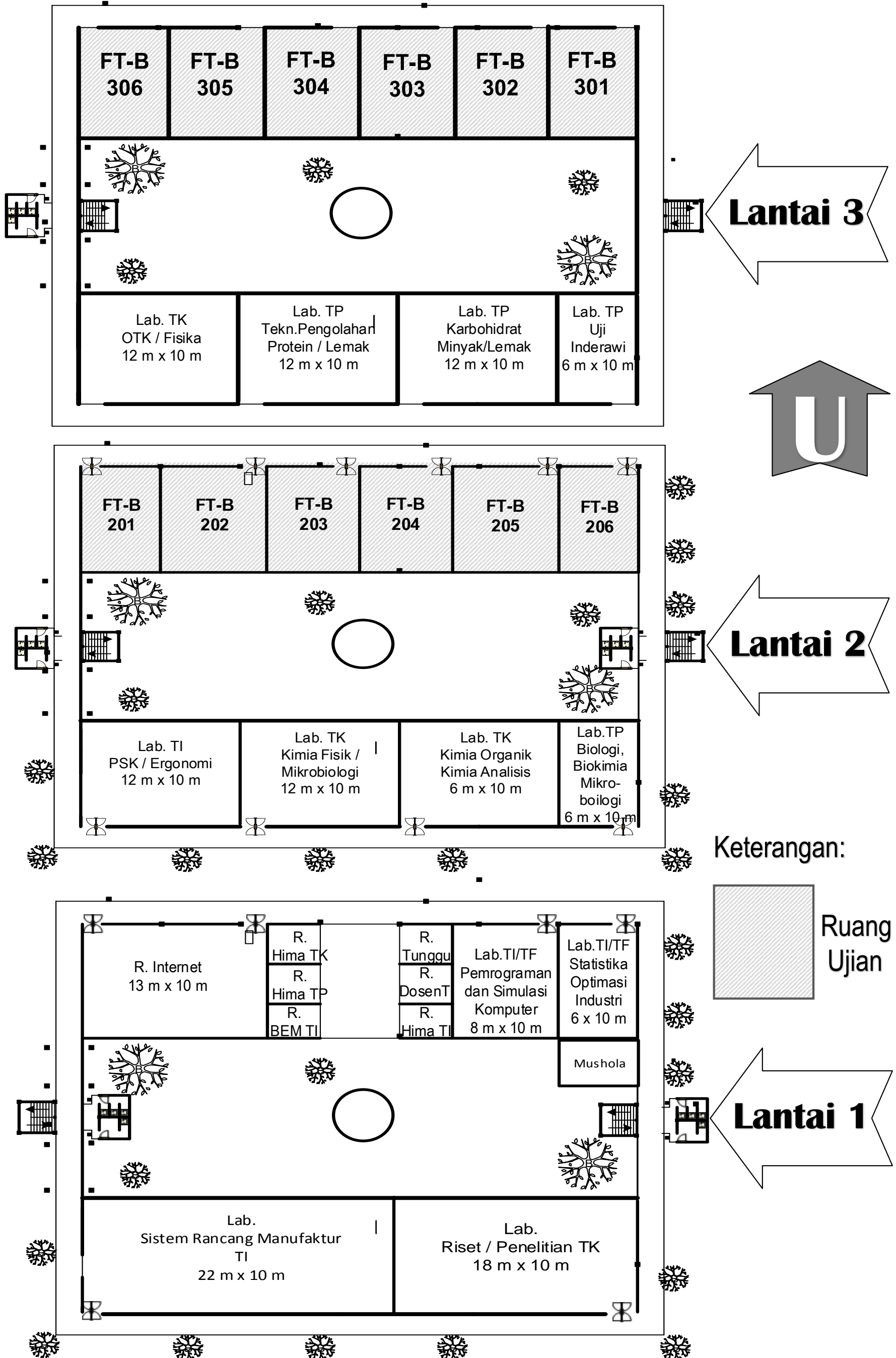

# DENAH RUANG UJIAN SBMPTN FIK

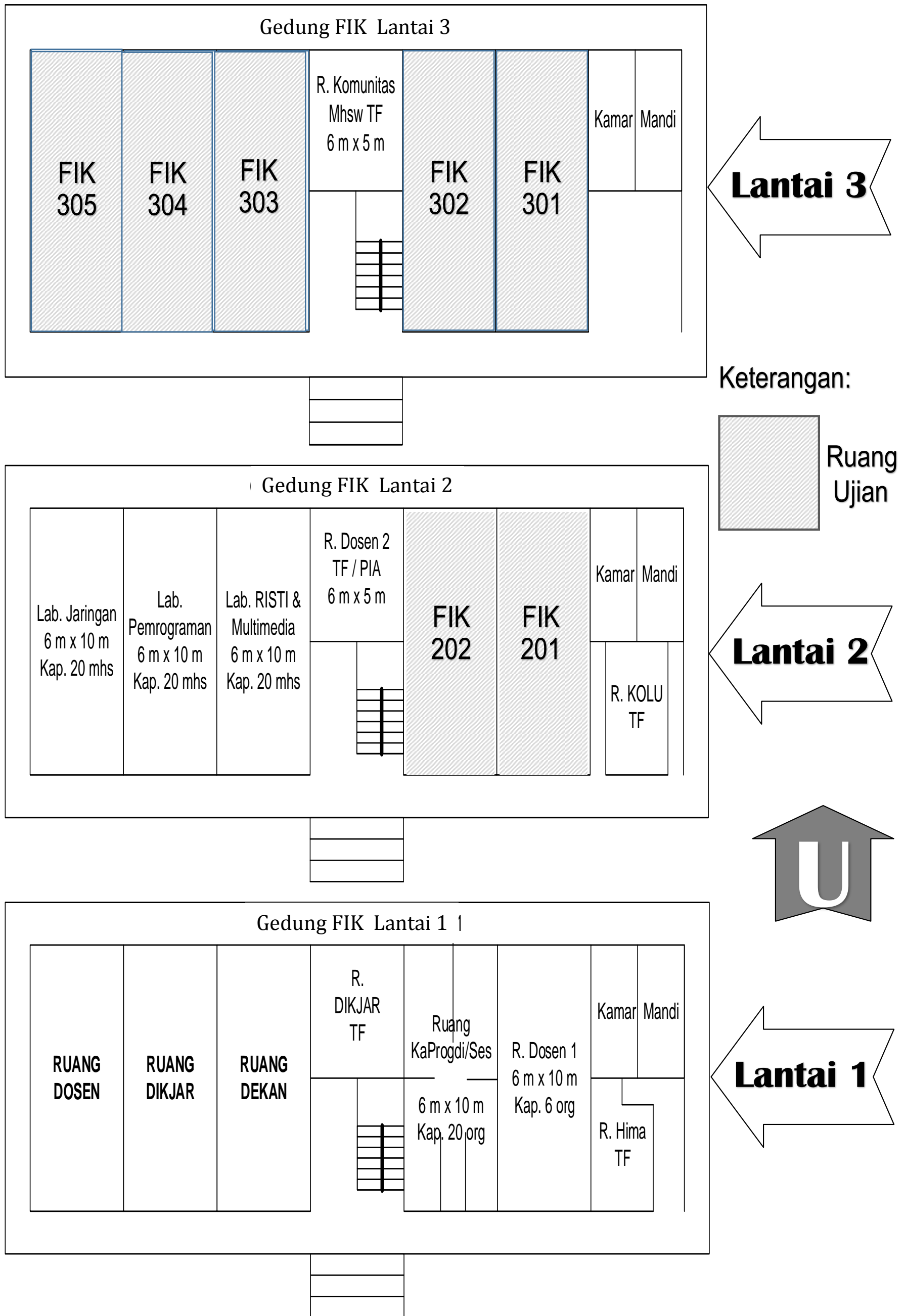

# DENAH RUANG UJIAN SBMPTN FISIP - A

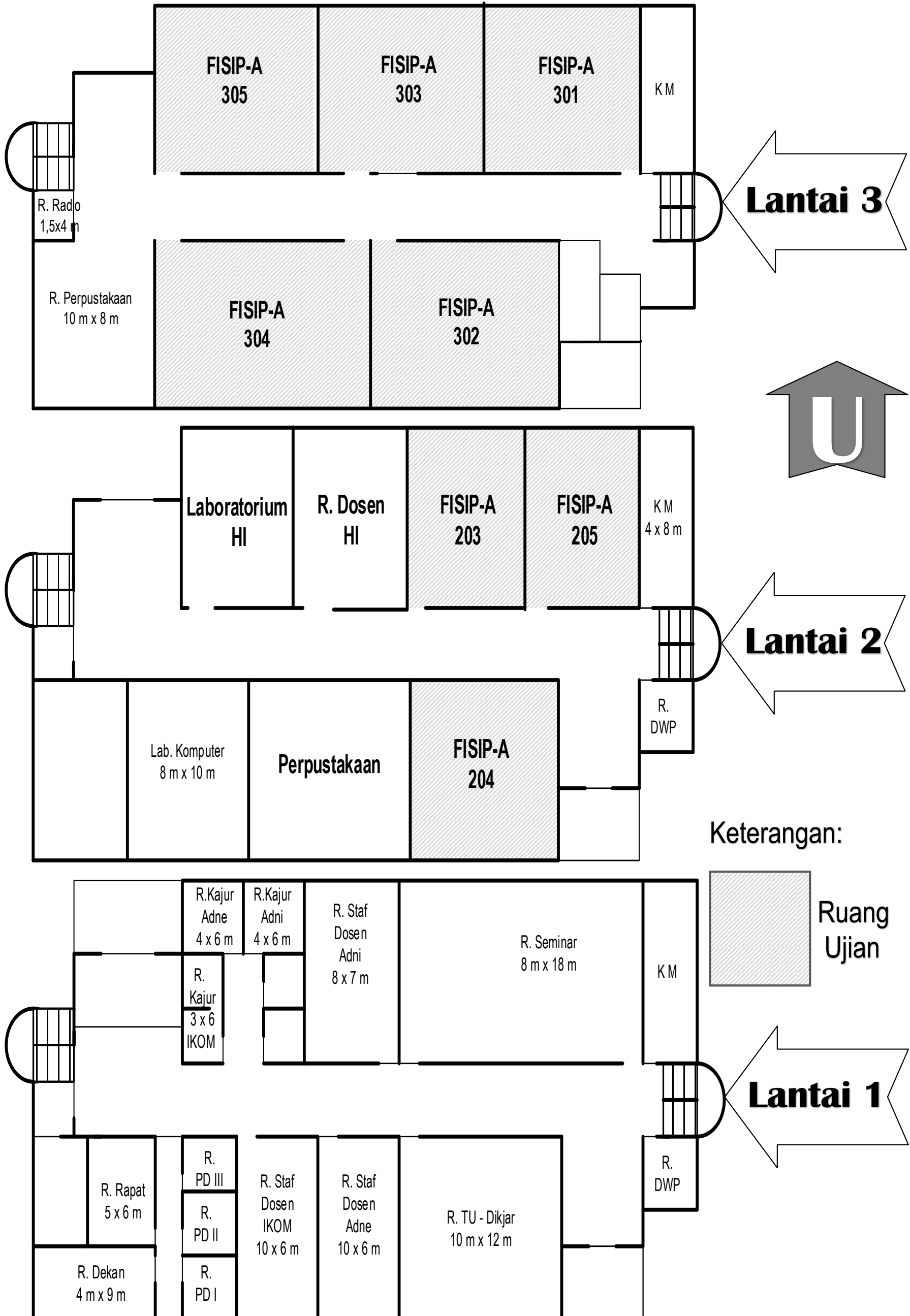



# DENAH RUANG UJIAN SBMPTN FISIP - B

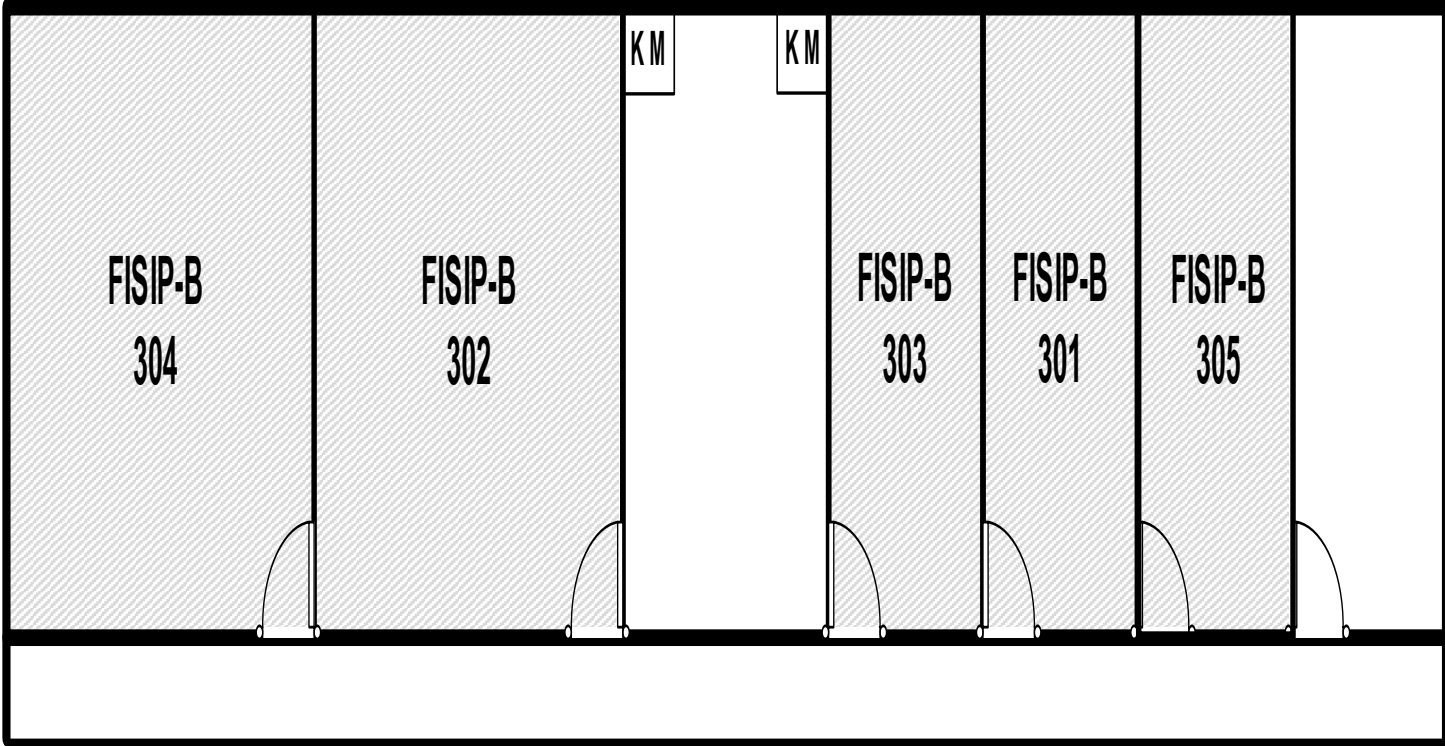

**Lantai 3**

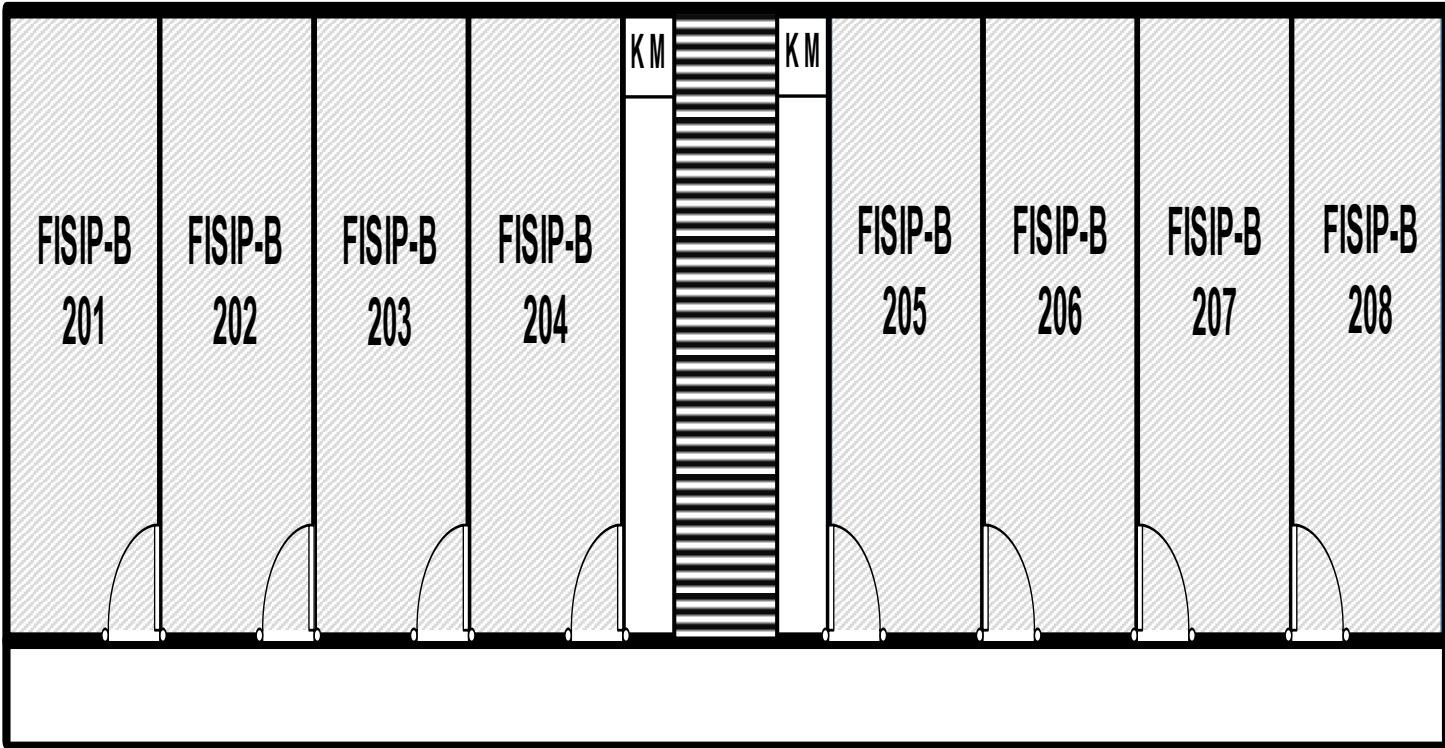
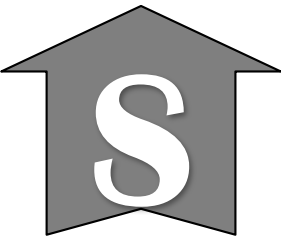

**Lantai 2**

Keterangan:

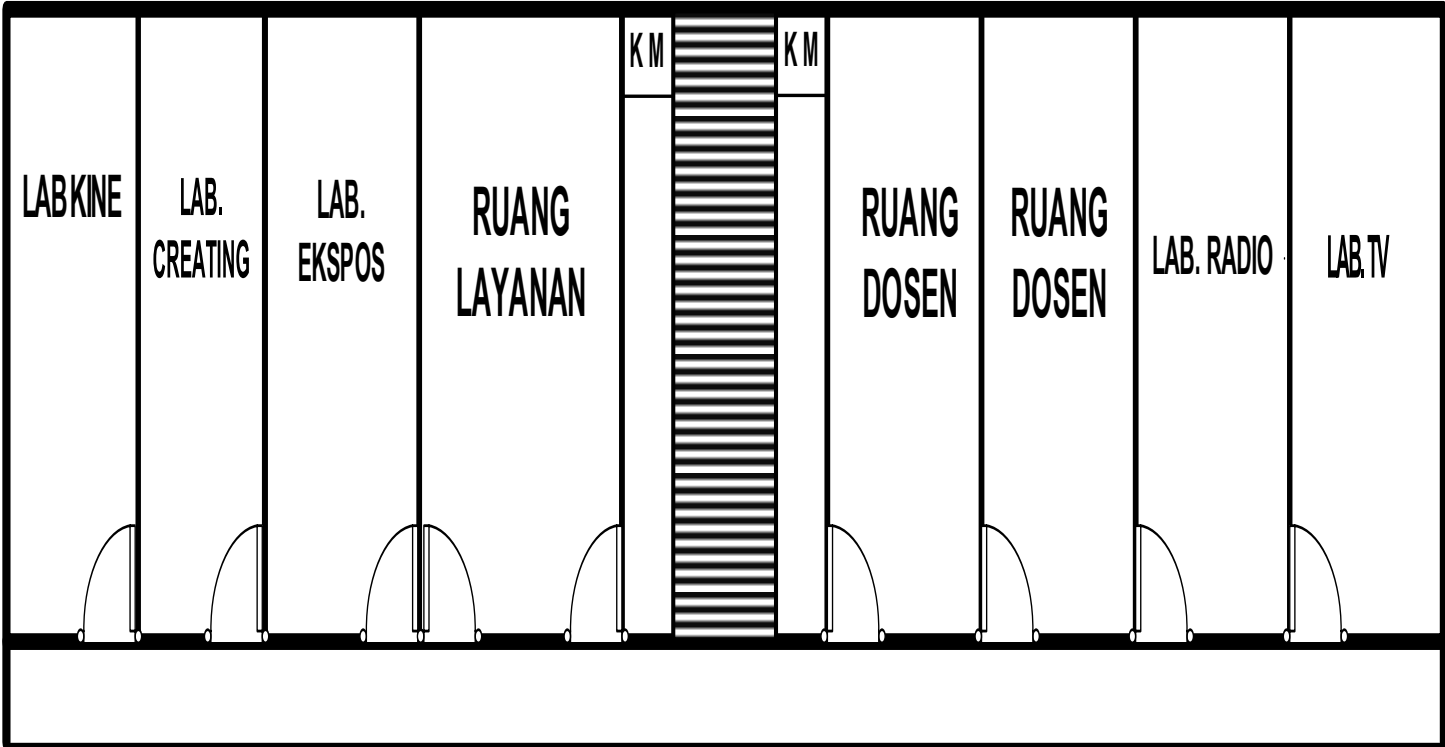
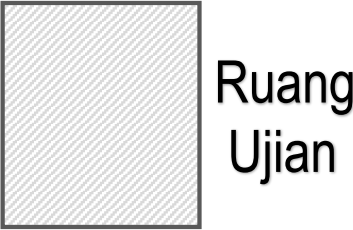

**Lantai 1**

# DENAH RUANG UJIAN SBMPTN FAD

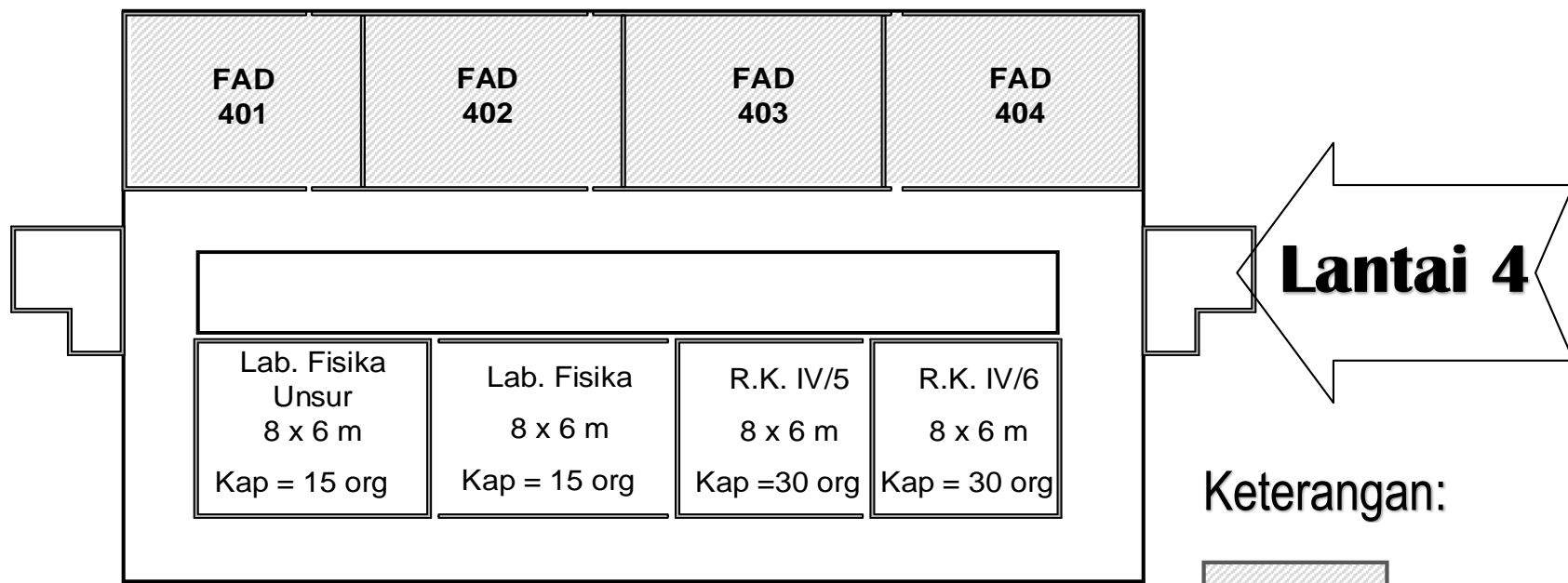

Keterangan:



## DENAH RUANG FAKULTAS ARSITEKTUR DAN DESAIN

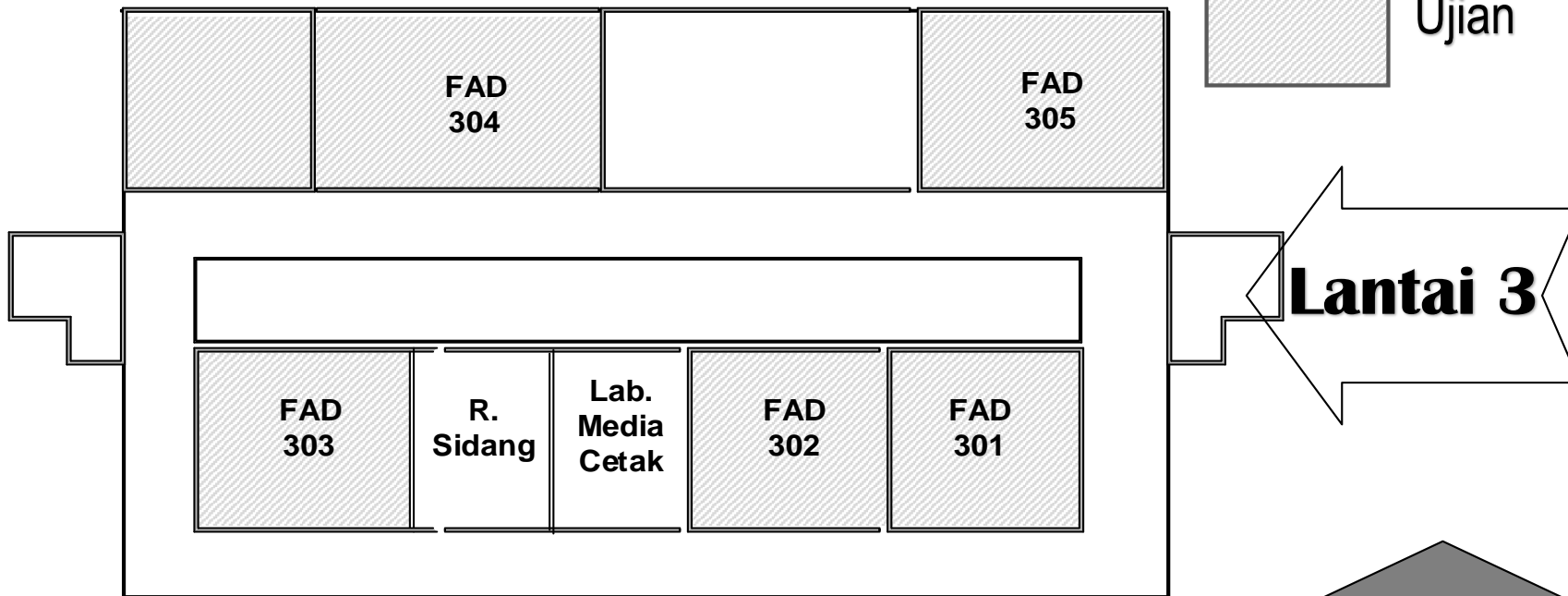

## Denah Lt. 2 Gedung FAD

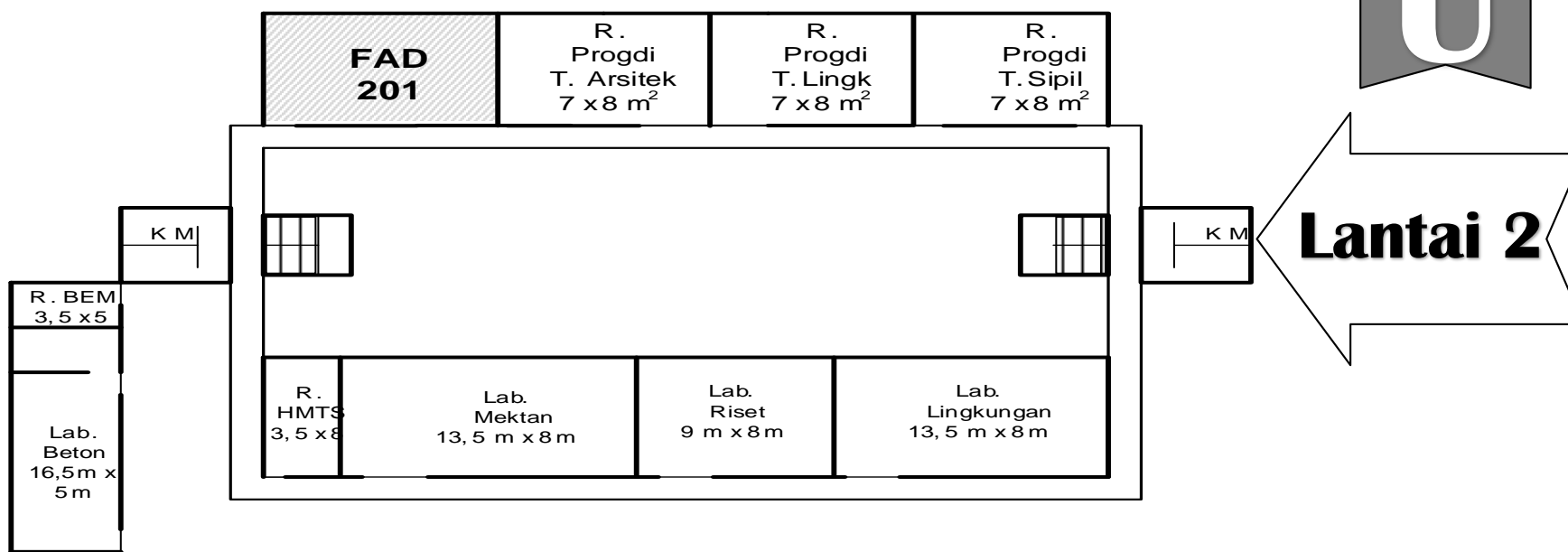

## Denah Lt. 1 Gedung FAD

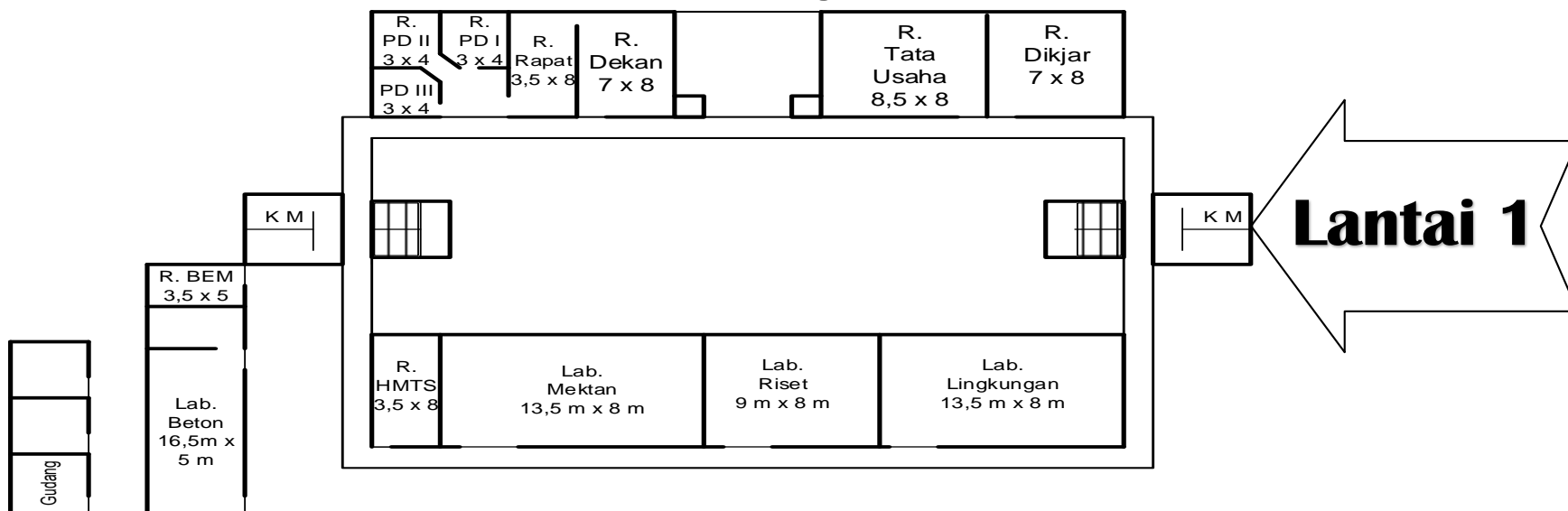

# DENAH RUANG UJIAN SBMPTN FH

## DENAH RUANG FAKULTAS HUKUM LANTAI III

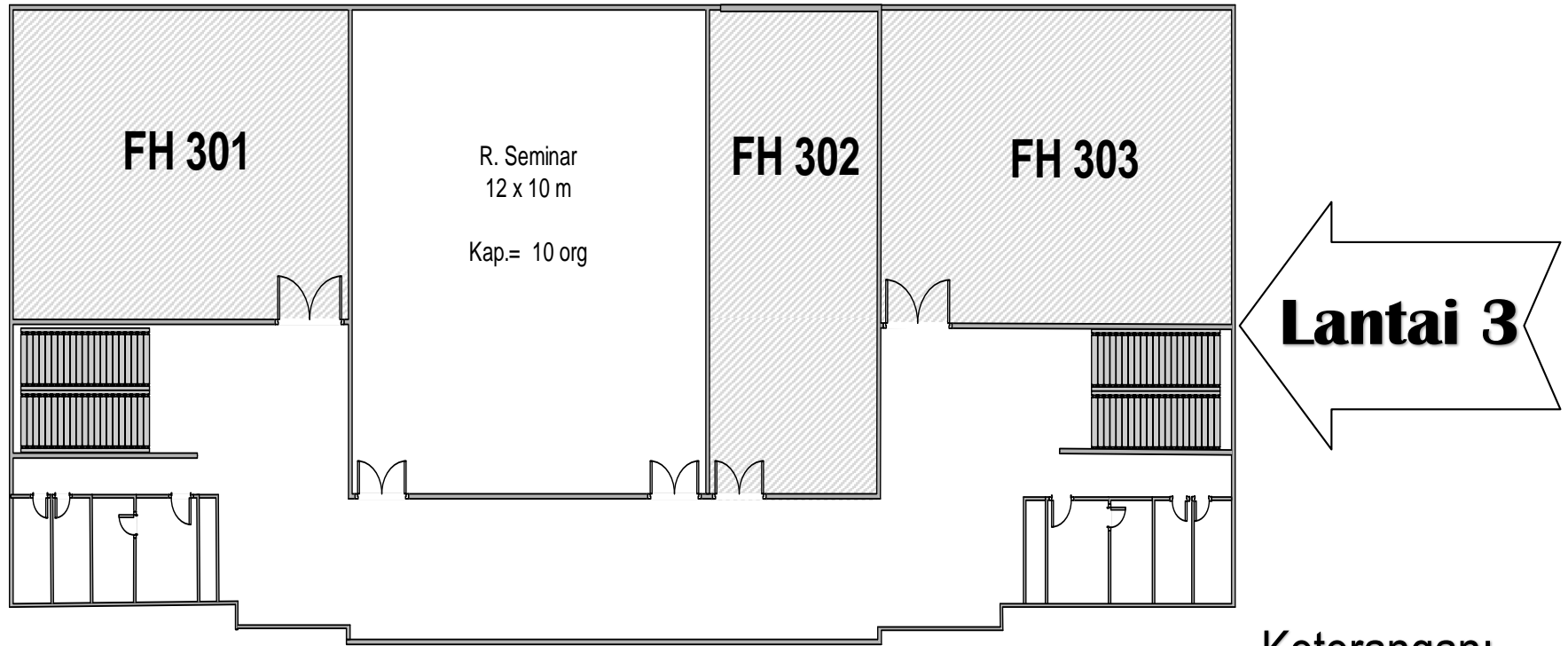

Keterangan:

## DENAH RUANG FAKULTAS HUKUM LANTAI II

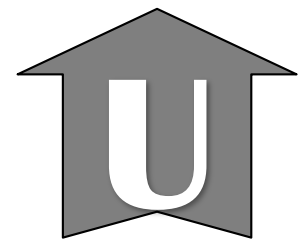
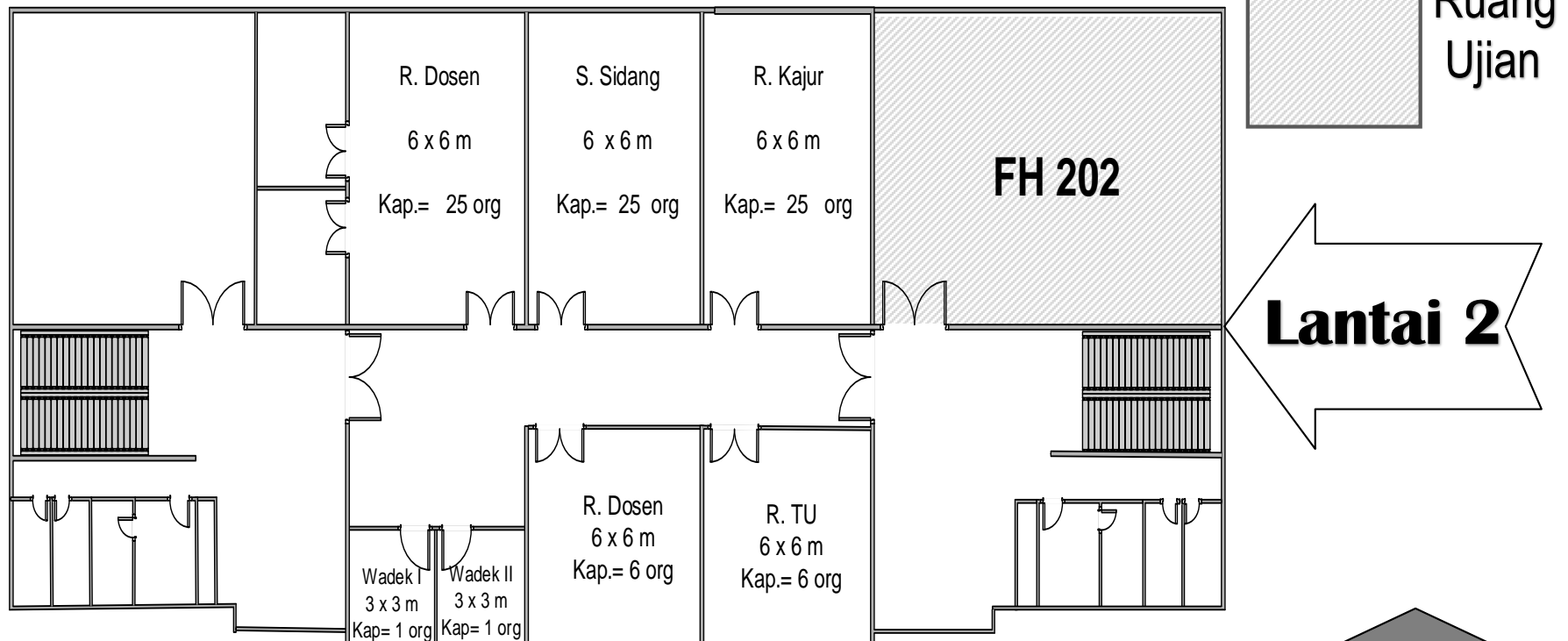

## DENAH RUANG FAKULTAS HUKUM LANTAI I

